

Konzentrische Reduzierungen Concentric Reducers, DT-11

IMPERIAL

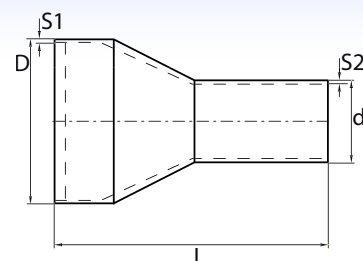

Inch	D/d mm	S1/S2	L mm
3/8" x 1/4"	9.53 x 6.35	0.89 / 0.89	38.00
1/2" x 1/4"	12.70 x 6.35	1.24 / 0.89	38.00
x 1/4"	x 6.35	1.65 / 0.89	38.00
x 3/8"	x 9.53	1.24 / 0.89	38.00
x 3/8"	x 9.53	1.65 / 0.89	38.00
3/4" x 1/4"	19.05 x 6.35	1.24 / 0.89	38.00
x 3/8"	x 9.53	1.24 / 0.89	60.00
x 3/8"	x 9.53	1.65 / 0.89	60.00
x 1/2"	x 12.70	1.24 / 1.24	60.00
x 1/2"	x 12.70	1.65 / 1.24	60.00
x 1/2"	x 12.70	1.65 / 1.65	60.00
1" x 1/2"	25.40 x 12.70	1.65 / 1.24	60.00
x 1/2"	x 12.70	1.65 / 1.65	60.00
x 3/4"	x 19.05	1.65 / 1.24	60.00
x 3/4"	x 19.05	1.65 / 1.65	60.00
1 1/2" x 1/2"	38.10 x 12.70	1.65 / 1.24	80.00
x 1/2"	x 12.70	1.65 / 1.65	80.00
x 3/4"	x 19.05	1.65 / 1.65	80.00
x 3/4"	x 19.05	1.65 / 1.24	80.00
x 1"	x 25.40	1.65 / 1.65	80.00
2" x 1"	50.80 x 25.40	1.65 / 1.65	90.00
x 1 1/2"	x 38.10	1.65 / 1.65	90.00
2 1/2" x 1"	63.50 x 25.40	1.65 / 1.65	100.00
x 1 1/2"	x 38.10	1.65 / 1.65	100.00
x 2"	x 50.80	1.65 / 1.65	100.00
3" x 1 1/2"	76.20 x 38.10	1.65 / 1.65	100.00
x 2"	x 50.80	1.65 / 1.65	110.00
x 2 1/2"	x 63.50	1.65 / 1.65	110.00
4" x 2"	101.60 x 50.80	2.11 x 1.65	135.00
x 2 1/2"	x 63.50	2.11 / 1.65	135.00
x 3"	x 76.20	2.11 / 1.65	135.00
6" x 4"	152.40 x 101.60	2.77 / 2.11	170.00

Konzentrische Reduzierungen Concentric Reducers, DT-11

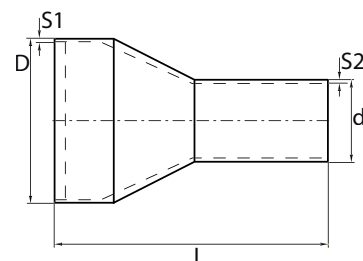

METRIC

DN / NW	d mm	S mm	l mm
6 x 4	8.00 x 6.00	1.00 / 1.00	38.00
8 x 4	10 x 6.00	1.00 / 1.00	38.00
x 6	x 8.00	1.00 / 1.00	38.00
10 x 4	12.00 x 6.00	1.00 / 1.00	38.00
x 6	x 8.00	1.00 / 1.00	38.00
x 8	x 10.00	1.00 / 1.00	38.00
15 x 8	18.00 x 10.00	1.50 / 1.00	38.00
x 10	x 12.00	1.50 / 1.00	38.00
20 x 10	23.00 x 12.00	1.50 / 1.00	60.00
x 10	x 18.00	1.50 / 1.50	60.00
32 x 15	35.00 x 23.00	1.50 / 1.50	80.00